

RETAILONICS

**Retail Fixtures
and
Supplies**



(877)785-6642 FAX (262) 878-5030 6804 Greenbay Rd., Suite 114, Unit 116, Kenosha, WI 53142

E-Mail: Sales@Retailonics.com

www.Retailonics.com



RETAILONICS

About Us

Company Information

Counter Systems

Page#

Platinum Full Vision Showcases	1
Platinum Extra Full Vision Showcases	2
Platinum Half Vision Showcases	3
Platinum Jewelry Vision Showcases	4
Classic Showcases Overview	5
Full Vision Showcases	6
Half Vision Showcases	7
Extra Vision Showcases	8
Jewelry Showcases	9
Open Seller Showcases	10
Check Out Counters & Bag Bins	11
Wrap Counters / Check Ledge	12
Register Stands	13
Corner Fillers	14

Wall Units

Glass Shelf Wall Units	15
------------------------	----

Service Area Stations

Basic & Deluxe Serving Stations	16
Reservation Stand & Display Risers	17
Storage Counters	18
Fountain Units	19
Condiment Units	20
Coffee Bar & Waste Units	21

Merchandising Items & Supplies

Three Tier & Four Tier Merchandising Tables	22
Display Tables & Wood Shelves	23
Slatwall Counters & Glass Island Displays	24
Slatwall Merchandising Systems	25
Locking Storage Cabinets	26
Bins & Spinners	27
Wire Shelving Racks	28
Adjustable Display Racks	29
Merchandise / Literature / Newspaper Racks	30
Write-On & Wash Off A-Frame / Counter Racks	31
Slatgrid, Standard Grid Panels & Displayers	32
Shelving	33
Merchandising Impulse Table & Sure'N Fast Detector	34
Custom Neon & LED Signs	35



RETAILONICS

Retailonics Corporation was created to offer our customers old-world craftsmanship at an affordable price. Through the latest in manufacturing techniques and years of experience we are able to present you with outstanding quality and exceptional service that are unmatched in the industry.

From CAD based designs and layout to nationwide delivery and installation services, Retailonics is your source for custom projects.

From a small doctors office to a complete retail store renovation no job is too big or too small. We pride ourselves on skilled craftsmanship and outstanding customer satisfaction.

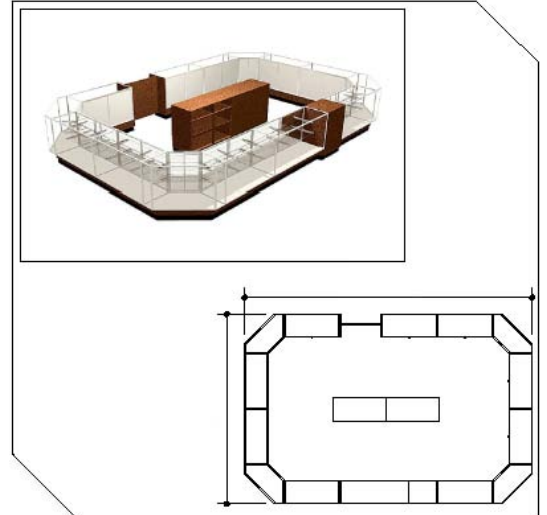

Let us quote on a new or existing project to show you the value that Retailonics can bring to your company.

Retailonics wants to be your complete source for all your custom millwork needs.

**1 Year Guarantee
on All Woodwork!**

Phone 877-785-6642

Fax 262-878-5030

Email: Sales@Retailonics.com



RETAILONICS

Mix and Match our stock components to give your shop a custom look at an affordable price



Phone 877-785-6642

Fax 262-878-5030

Email: Sales@Retailonics.com



RETAILONICS

Standard Colors

Standard Finishes

Finish Numbers:



01- Almond



02- Black



03- Gray

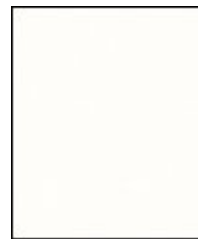

04- White



06- Maple

Wood Grain Finishes

Finish Numbers:



05- Cherry



07- Walnut



08- Medium
Oak

Custom High Pressure Laminate finishes are available from Formica, Wilsonart and Nevamar. Please contact us for more information.

Phone 877-785-6642

Fax 262-878-5030

Email: Sales@Retailonics.com



RETAILONICS

Platinum Collection

The platinum collection offers an elegant and modern presentation with unlimited display flexibility at an affordable price.

Platinum Line Standard Features:

- Tempered top, sides and front glass
- 6"H black toe kick
- White interior deck and 1/4" wood rear sliding doors
- Satin brushed anodized finish aluminum extrusions
- Steel interior standards & brackets to match
- 38" high, 20" deep, available in 48", 60" or 72" widths

Platinum Full Vision Showcase

Features:

- 24" High front viewing area
- Adjustable standards, 3/16" glass shelves
8" & 10" Deep (includes brackets)

Item#	Width	Depth	Weight
PFV48##	48"	20"	230
PFV60##	60"	20"	250
PFV72##	72"	20"	265

##-Specify finish (low pressure laminate matte finish)
Standard finish: 01-Almond 02-Black 03-Gray 04-White 06-Maple
Woodgrain finish: 05-Cherry 07-Walnut 08-Medium Oak

Showcase Options:

Item#	Description
FL##	Fluorescent light fixture
RL	Ratchet lock
PL	Plunger lock
PFVMD	Mirrored doors (rear sliding)
PFVGD	Front opening glass doors w/solid wood back
PFVHPL	Additional charge for exterior HPL finish
CS	Casters set
PFVHPLRD	HPL exterior 1/4" rear sliding doors

##-Specify width when ordering.

Custom HPL finishes are available from Formica, Wilsonart, and Nevamar. Allow a 3-4 week lead time. Solid colors or woodgrains in matte finish only. All other brands and finishes priced upon request. Additional crating charge \$20.00 per unit. Shipping weights are approximate per crate.

Front View

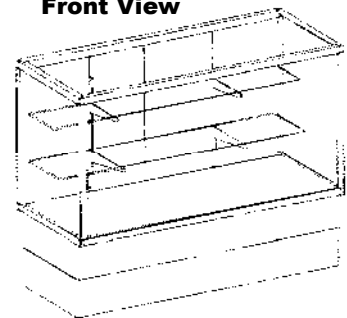

Back View

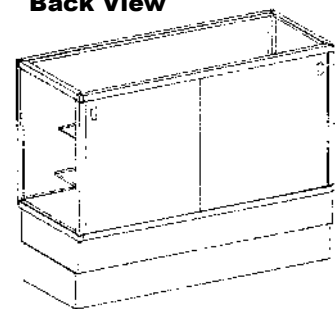

Phone 877-785-6642

Fax 262-878-5030

Email: Sales@Retailonics.com



Platinum Extra Vision Showcase

Features:

- **Tempered top, sides and front glass**
- **6"H black toe kick**
- **31"H front viewing area**
- **Adjustable standards, 3/16" glass shelves 8" & 10" Deep (includes brackets)**

Item#	Width	Depth	Weight
PEV4802	48"	20"	230
PEV6002	60"	20"	250
PEV7202	72"	20"	265

Stock base available in 02-black finish

Showcase Options:

Item#	Description
FL##	Fluorescent light fixture
RL	Ratchet lock
PL	Plunger lock
PEVMD	Mirrored doors (rear sliding)
PEVGD	Front opening glass doors w/solid wood back
PEVHPL	Additional charge for exterior HPL finish
CS	Casters set
PEVHPLRD	HPL exterior 1/4" rear sliding doors

##-Specify width when ordering.

Custom HPL finishes are available from Formica, Wilsonart, and Nevamar. Allow a 3-4 week lead time. Solid colors or woodgrains in matte finish only. All other brands and finishes priced upon request.

Additional Glass Shelves:

Item#	Showcase Dimension	Shelf Dimension
GS824	48"	8" X 24"
GS1024	48"	10" X 24"
GS1224	48"	12" X 24"
GS830	60"	8" X 30"
GS1030	60"	10" X 30"
GS1230	60"	12" X 30"
GS835	72"	8" X 35"
GS1035	72"	10" X 35"
GS1235	72"	12" X 35"
BKT08	8" Bracket with clips	
BKT10	10" Bracket with clips	
BKT12	12" Bracket with clips	

Additional crating charge \$20.00 per unit. Shipping weights are approximate per crate.

Front View

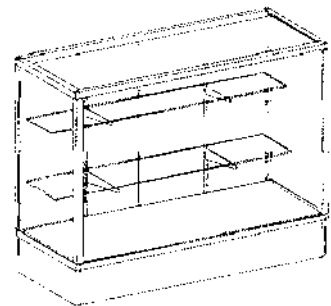

Back View

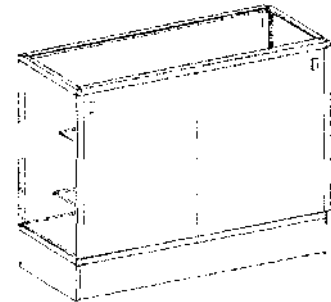



Platinum Half Vision Showcase

Features:

- **Tempered top, sides and front glass**
- **6"H black toe kick**
- **18"H front viewing area**
- **Adjustable standards, 3/16" glass shelf – 10" Deep (brackets included)**

Item#	Width	Depth	Weight
PHV48##	48"	20"	230
PHV60##	60"	20"	250
PHV72##	72"	20"	265

##-Specify finish (low pressure laminate matte finish)
Standard finish: 01-Almond 02-Black 03-Gray 04-White 06-Maple
Woodgrain finish: 05-Cherry 07-Walnut 08-Medium Oak

Front View

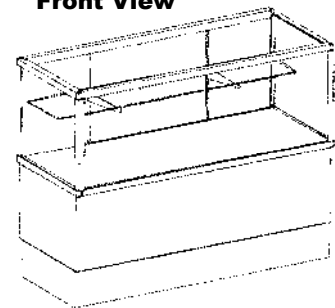

Showcase Options:

Item#	Description
FL##	Fluorescent light fixture
RL	Ratchet lock
PL	Plunger lock
PHVMD	Mirrored doors (rear sliding)
PHVGD	Front opening glass doors w/solid wood back
PHVHPL	Additional charge for exterior HPL finish
CS	Casters set
PHVHPLRD	HPL exterior 1/4" rear sliding doors

##-Specify width when ordering.

Custom HPL finishes are available from Formica, Wilsonart, and Nevamar. Allow a 3-4 week lead time. Solid colors or woodgrains in matte finish only. All other brands and finishes priced upon request.

Additional Glass Shelves:

Item#	Showcase Dimension	Shelf Dimension
GS824	48"	8" X 24"
GS1024	48"	10" X 24"
GS1224	48"	12" X 24"
GS830	60"	8" X 30"
GS1030	60"	10" X 30"
GS1230	60"	12" X 30"
GS835	72"	8" X 35"
GS1035	72"	10" X 35"
GS1235	72"	12" X 35"
BKT08	8" Bracket with clips	
BKT10	10" Bracket with clips	
BKT12	12" Bracket with clips	

Back View

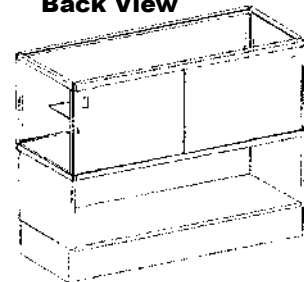

Additional crating charge \$20.00 per unit. Shipping weights are approximate per crate.



Platinum Jewelry Vision Showcase

Features:

- **Tempered top, sides and front glass**
- **6"H black toe kick**
- **13"H front viewing area**
- **One lower rear storage area with one 3/4" adjustable shelf**

Item#	Width	Depth	Weight
PJV48##	48"	20"	230
PJV60##	60"	20"	250
PJV72##	72"	20"	265

##-Specify finish (low pressure laminate matte finish)
Standard finish: 01-Almond 02-Black 03-Gray 04-White 06-Maple
Woodgrain finish: 05-Cherry 07-Walnut 08-Medium Oak

Showcase Options:

Item#	Description
FL##	Fluorescent light fixture
RL	Ratchet lock
PL	Plunger lock
PJVMD	Mirrored doors (rear sliding)
PJVGD	Front opening glass doors w/solid wood back
PJVJPL	Additional charge for exterior HPL finish
CS	Casters set
PJVJPLRD	HPL exterior 1/4" rear sliding doors

Front View

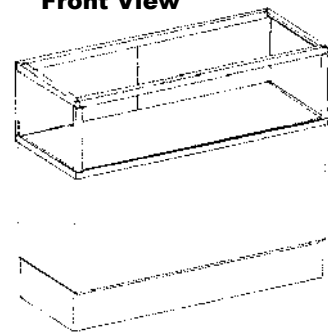

##-Specify width when ordering.

Custom HPL finishes are available from Formica, Wilsonart, and Nevamar. Allow a 3-4 week lead time. Solid colors or woodgrains in matte finish only. All other brands and finishes priced upon request.

Additional Glass Shelves:

Item#	Showcase Dimension	Shelf Dimension
GS824	48"	8" X 24"
GS1024	48"	10" X 24"
GS1224	48"	12" X 24"
GS830	60"	8" X 30"
GS1030	60"	10" X 30"
GS1230	60"	12" X 30"
GS835	72"	8" X 35"
GS1035	72"	10" X 35"
GS1235	72"	12" X 35"
BKT08	8" Bracket with clips	
BKT10	10" Bracket with clips	
BKT12	12" Bracket with clips	

Back View

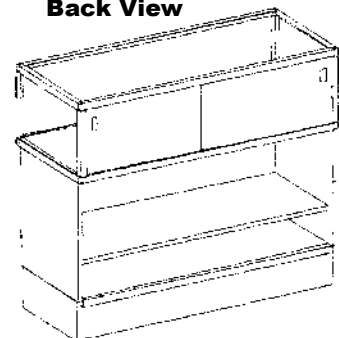

Additional crating charge \$20.00 per unit. Shipping weights are approximate per crate.



RETAILONICS

Classic Showcases

Contemporary design for high impact displays. The modular styling provides superior quality and function at an affordable price.

Features:

- Durable $\frac{3}{4}$ " laminate construction
- White interior deck and $\frac{1}{4}$ " wood rear sliding doors
- Satin brushed anodized finish aluminum extrusions
- Steel interior standards and brackets to match
- 38" high, available in 18" or 24" depths and 48", 60" or 70" widths
- All lights are hard wired – An electrician will have to install plug

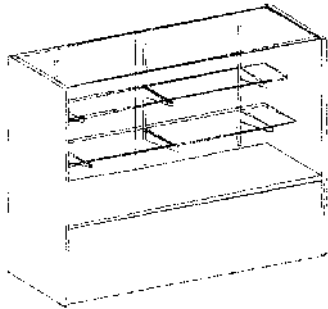

Full Vision Showcase

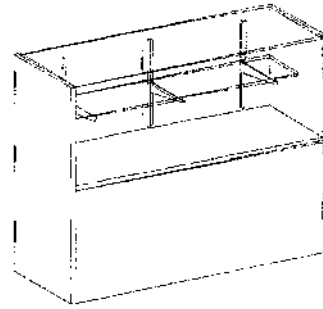

Half Vision Showcase

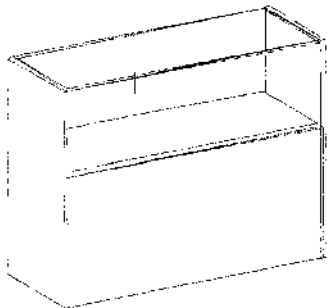

Jewelry Vision Showcase

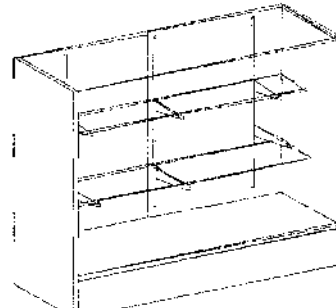

Extra Vision Showcase

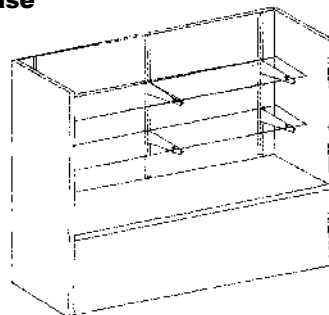

Open Seller Showcase

Phone 877-785-6642

Fax 262-878-5030

Email: Sales@Retailonics.com



Full Vision Showcase

Features:

- Tempered top and front glass
- 24"H front viewing area
- Two rows adjustable standards, 3/16" glass shelves (includes brackets)
- 18" showcase features 8" & 10" shelves
- 24" showcase features 10" & 12" shelves

Item#	Width	Depth	Weight
FV4818##	48"	18"	230
FV4824##	48"	24"	250
FV6018##	60"	18"	250
FV6024##	60"	24"	275
FV7018##	70"	18"	265
FV7024##	70"	24"	295

##-Specify finish (low pressure laminate matte finish)
Standard finish: 01-Almond 02-Black 03-Gray 04-White 06-Maple
Woodgrain finish: 05-Cherry 07-Walnut 08-Medium Oak

Front View

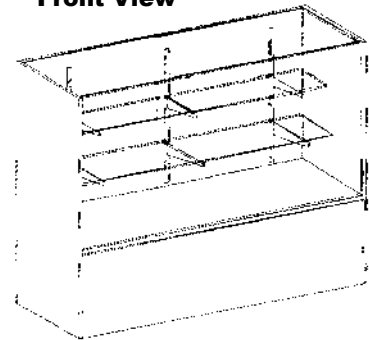

Showcase Options:

Item#	Description
FL##	Fluorescent light fixture
RL	Ratchet lock
PL	Plunger lock
FVMD	Mirrored doors (rear sliding)
FVGD	Front opening glass doors w/solid wood back
FVHPL	Additional charge for exterior HPL finish
CS	Casters set
FVHPLRD	HPL exterior 1/4" rear sliding doors

##-Specify width when ordering.

Custom HPL finishes are available from Formica, Wilsonart, and Nevamar. Allow a 3-4 week lead time. Solid colors or woodgrains in matte finish only. All other brands and finishes priced upon request.

Additional Glass Shelves:

Item#	Showcase Dimension	Shelf Dimension
GS824	48"	8" X 24"
GS1024	48"	10" X 24"
GS1224	48"	12" X 24"
GS830	60"	8" X 30"
GS1030	60"	10" X 30"
GS1230	60"	12" X 30"
GS835	72"	8" X 35"
GS1035	72"	10" X 35"
GS1235	72"	12" X 35"
BKT08	8" Bracket with clips	
BKT10	10" bracket with clips	
BKT12	12" Bracket with clips	

Back View

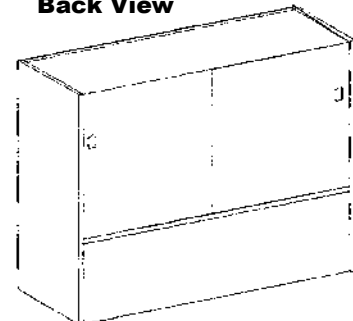

Additional crating charge \$20.00 per unit. Shipping weights are approximate per crate.

Phone 877-785-6642 Fax 262-878-5030 Email: Sales@Retailonics.com



Half Vision Showcase

Features:

- Tempered top and front glass
- 18"H front viewing area
- One row adjustable standards, 3/16" glass shelves (includes brackets)
- 10" D in 18" Unit, 12" D in 24" Unit
- Open lower rear storage area

Item#	Width	Depth	Weight
HV4818##	48"	18"	230
HV4824##	48"	24"	250
HV6018##	60"	18"	250
HV6024##	60"	24"	275
HV7018##	70"	18"	265
HV7024##	70"	24"	295

##-Specify finish (low pressure laminate matte finish)
Standard finish: 01-Almond 02-Black 03-Gray 04-White 06-Maple
Woodgrain finish: 05-Cherry 07-Walnut 08-Medium Oak

Front View

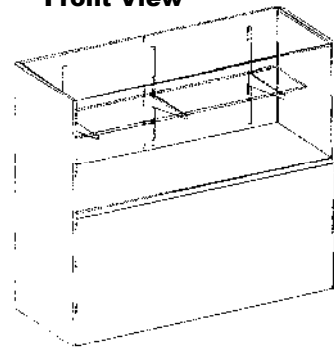

Showcase Options:

Item#	Description
FL##	Fluorescent light fixture
RL	Ratchet lock
PL	Plunger lock
HVMD	Mirrored doors (rear sliding)
HVGD	Front opening glass doors w/solid wood back
HVHPL	Additional charge for exterior HPL finish
CS	Casters set
HVLS	1/4" white lower storage doors
HVHPLRD	HPL exterior 1/4" rear sliding doors

##-Specify width when ordering.

Custom HPL finishes are available from Formica, Wilsonart, and Nevamar. Allow a 3-4 week lead time. Solid colors or woodgrains in matte finish only. All other brands and finishes priced upon request.

Additional Glass Shelves:

Item#	Showcase Dimension	Shelf Dimension
GS824	48"	8" X 24"
GS1024	48"	10" X 24"
GS1224	48"	12" X 24"
GS830	60"	8" X 30"
GS1030	60"	10" X 30"
GS1230	60"	12" X 30"
GS835	72"	8" X 35"
GS1035	72"	10" X 35"
GS1235	72"	12" X 35"
BKT08	8" Bracket with clips	
BKT10	10" Bracket with clips	
BKT12	12" Bracket with clips	

Back View

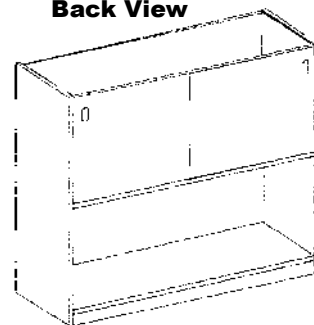

Additional crating charge \$20.00 per unit. Shipping weights are approximate per crate.

Phone 877-785-6642 Fax 262-878-5030 Email: Sales@Retailonics.com



Extra Vision Showcase

Features:

- Tempered top and front glass
- 31"H front viewing area
- Two rows adjustable standards, 3/16" glass shelves (includes brackets)

Item#	Width	Depth	Weight
EV4818##	48"	18"	230
EV4824##	48"	24"	250
EV6018##	60"	18"	250
EV6024##	60"	24"	275
EV7018##	70"	18"	265
EV7024##	70"	24"	295

Front View

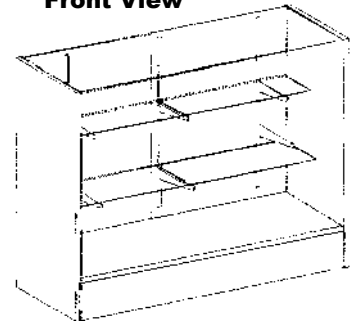

##-Specify finish (low pressure laminate matte finish)

**Standard finish: 01-Almond 02-Black 03-Gray 04-White 06-Maple
Woodgrain finish: 05-Cherry 07-Walnut 08-Medium Oak**

Showcase Options:

Item#	Description
FL##	Fluorescent light fixture
RL	Ratchet lock
PL	Plunger lock
EVMD	Mirrored doors (rear sliding)
EVGD	Front opening glass doors w/solid wood back
EVHPL	Additional charge for exterior HPL finish
CS	Casters set
EVHPLRD	HPL exterior 1/4" rear sliding doors

##-Specify width when ordering.

Custom HPL finishes are available from Formica, Wilsonart, and Nevamar. Allow a 3-4 week lead time. Solid colors or woodgrains in matte finish only. All other brands and finishes priced upon request.

Additional Glass Shelves:

Item#	Showcase Dimension	Shelf Dimension
GS824	48"	8" X 24"
GS1024	48"	10" X 24"
GS1224	48"	12" X 24"
GS830	60"	8" X 30"
GS1030	60"	10" X 30"
GS1230	60"	12" X 30"
GS835	72"	8" X 35"
GS1035	72"	10" X 35"
GS1235	72"	12" X 35"
BKT08	8" Bracket with clips	
BKT10	10" Bracket with clips	
BKT12	12" Bracket with clips	

Back View

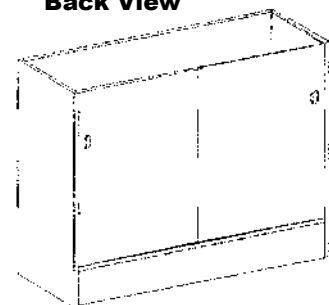

Additional crating charge \$20.00 per unit. Shipping weights are approximate per crate.



Jewelry Showcase

Features:

- Tempered top glass
- 13"H front viewing area
- One rear storage area with 3/4" adjustable storage shelf

Item#	Width	Depth	Weight
JS4818##	48"	18"	230
JS4824##	48"	24"	250
JS6018##	60"	18"	250
JS6024##	60"	24"	275
JS7018##	70"	18"	265
JS7024##	70"	24"	295

Front View

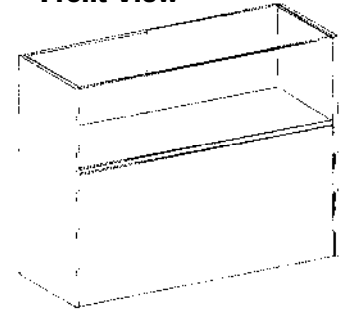

##-Specify finish (low pressure laminate matte finish)

Standard finish: 01-Almond 02-Black 03-Gray 04-White 06-Maple

Woodgrain finish: 05-Cherry 07-Walnut 08-Medium Oak

Showcase Options:

Item#	Description
FL##	Fluorescent light fixture
RL	Ratchet lock
PL	Plunger lock
JSM D	Mirrored doors (rear sliding)
JSG D	Front opening glass doors w/solid wood back
JSH PL	Additional charge for exterior HPL finish
JSL SD	1/4" white lower storage doors
CS	Casters set
JSH PL RD	HPL exterior 1/4" rear sliding doors

Back View

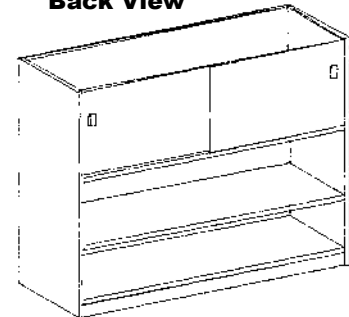

##-Specify width when ordering.

Custom HPL finishes are available from Formica, Wilsonart, and Nevamar. Allow a 3-4 week lead time. Solid colors or woodgrains in matte finish only. All other brands and finishes priced upon request.

Additional crating charge \$20.00 per unit. Shipping weights are approximate per crate.

Not finding what you are looking for?

At Retailonics, we have the ability to customize any fixture to meet the needs of your next project. We are experienced in a wide variety of materials including veneer, laminate, solid wood and glass.

Let our skilled craftsmen bring your project to life. Contact your sales representative for more information.



Open Seller Showcase

Features:

- **Solid Back with open display area (no top or front glass)**
- **26"H front viewing area**
- **Two rows adjustable standards, 3/16" glass shelves (brackets included)**

Item#	Width	Depth	Weight
HV4818##	48"	18"	230
HV4824##	48"	24"	250
HV6018##	60"	18"	250
HV6024##	60"	24"	275
HV7018##	70"	18"	265
HV7024##	70"	24"	295

Front View

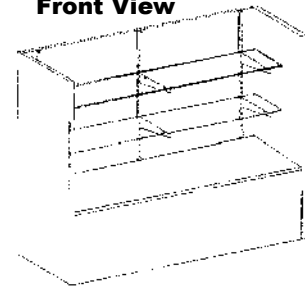

##-Specify finish (low pressure laminate matte finish)

**Standard finish: 01-Almond 02-Black 03-Gray 04-White 06-Maple
Woodgrain finish: 05-Cherry 07-Walnut 08-Medium Oak**

Showcase Options:

Item#	Description
OSHPL	Additional charge for exterior HPL finish
CS	Casters set

Custom HPL finishes are available from Formica, Wilsonart, and Nevamar. Allow a 3-4 week lead time. Solid colors or woodgrains in matte finish only. All other brands and finishes priced upon request.

Additional Glass Shelves:

Item#	Showcase Dimension	Shelf Dimension
GS824	48"	8" X 24"
GS1024	48"	10" X 24"
GS1224	48"	12" X 24"
GS830	60"	8" X 30"
GS1030	60"	10" X 30"
GS1230	60"	12" X 30"
GS835	72"	8" X 35"
GS1035	72"	10" X 35"
GS1235	72"	12" X 35"
BKT08	8" Bracket with clips	
BKT10	10" Bracket with clips	
BKT12	12" Bracket with clips	

Back View

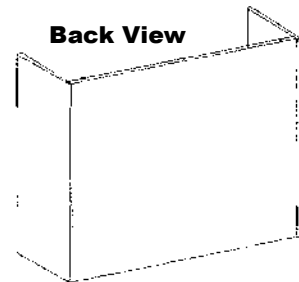

Additional crating charge \$20.00 per unit. Shipping weights are approximate per crate.



Checkout Counters

**These checkout counters make an excellent addition to any service environment
Due to their functional design and durable construction.**

Features:

- Durable 3/4" laminate construction
- Open storage area with 3/4" adjustable storage shelf
- Center divider panel for added support (60" & 70" widths only)

Item#	Width	Depth	Weight
CO4818##	48"	18"	200
CO4824##	48"	24"	220
CO6018##	60"	18"	225
CO6024##	60"	24"	250
CO7018##	70"	18"	240
CO7024##	70"	24"	270

Front View

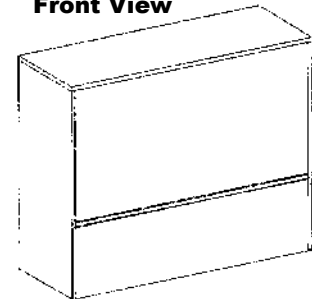

##-Specify finish (low pressure laminate matte finish)

Standard finish: 01-Almond 02-Black 03-Gray 04-White 06-Maple

Woodgrain finish: 05-Cherry 07-Walnut 08-Medium Oak

Counter Options:

Item#	Description
COS48	Additional shelf for 48" counter
COS60	Additional shelf for 60" counter (30" each)
COS70	Additional shelf for 70" counter (35" each)
COSD##	1/4" white wood rear sliding doors (per set)
RL	Ratchet lock
PL	Plunger lock
COHPL	Additional charge for exterior HPL finish

Back View

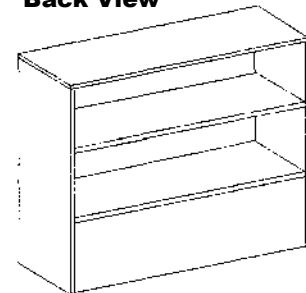

##-Specify width when ordering.

Custom HPL finishes are available from Formica, Wilsonart, and Nevamar. Allow a 3-4 week lead time. Solid colors or woodgrains in matte finish only. All other brands and finishes priced upon request.

Bag Bins

Features:

- Insert for wrap counter and checkout
- 1/4" grooves allow for approximately 6" spacing
- Removable 1/4" dividers
- Specify LPL black or white

Item#	Width	Height	Weight
BB488##	48"	8"	220
BB608##	60"	8"	250
BB708##	72"	8"	270

##-Specify finish (low pressure laminate matte finish)

Standard finish: 02-Black or 04-White Only

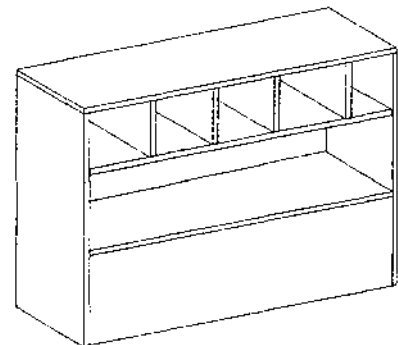



Wrap Counters

Similar to the checkout counter, these wrap counters offer the same functional design and durable construction. The 34" height meets ADA accessibility requirements.

Features:

- Durable 3/4" laminate construction
- Open storage area with 3/4" adjustable storage shelf
- Center divider panel for added support (60" & 70" widths only)

Item#	Width	Depth	Weight
WC4818##	48"	18"	195
WC4824##	48"	24"	215
WC6018##	60"	18"	220
WC6024##	60"	24"	245
WC7018##	70"	18"	235
WC7024##	70"	24"	265

##-Specify finish (low pressure laminate matte finish)
 Standard finish: 01-Almond 02-Black 03-Gray 04-White 06-Maple
 Woodgrain finish: 05-Cherry 07-Walnut 08-Medium Oak

Front View

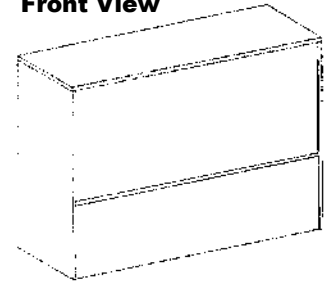

Back View

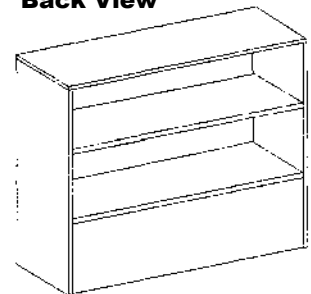

Check Ledge

Features:

- 8" high, 8" deep
- Attaches to wrap counter for an overall height of 42"
- Durable 3/4" melamine construction

Item#	Width	Depth	Weight
CL488##	48"	8"	16
CL608##	60"	8"	18
CL708##	72"	8"	20
CLHPL##	Additional charge for exterior HPL finish		

##-Specify finish (low pressure laminate matte finish)
 Standard finish: 01-Almond 02-Black 03-Gray 04-White 06-Maple
 Woodgrain finish: 05-Cherry 07-Walnut 08-Medium Oak

Additional crating charge \$20.00 per unit.
 Shipping weights are approximate per crate.

Front View

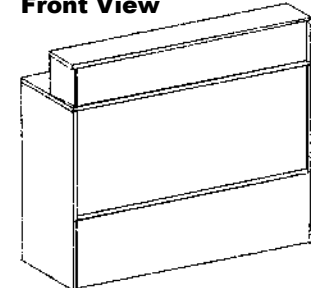

Back View

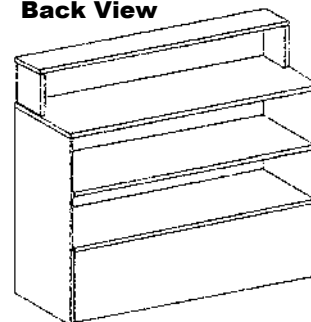



Register Stands

Designed with your needs in mind, these compact register stands will meet your highest expectations of durability and function. Register stands are 38" high and 24" wide.

Well Top Register Stand

Features:

- 4" recessed well top design
- Open storage area with 3/4" adjustable storage shelf

Item#	Width	Depth	Weight
WTR2418##	24"	18"	125
WTR2424##	24"	24"	140

Flat Top Register Stand

Features:

- Open storage area with 3/4" adjustable storage shelf

Item#	Width	Depth	Weight
FTR2418##	24"	18"	125
FTR2424##	24"	24"	140

Combo Register Stand

Features:

- 4" recessed well top design
- 20" High glass display area with one adjustable glass shelf
- 1/4" wood sliding doors standard

Item#	Width	Depth	Weight
CRS2418##	24"	18"	125
CRS2424##	24"	24"	140

##-Specify finish (low pressure laminate matte finish)
 Standard finish: 01-Almond 02-Black 03-Gray 04-White 06-Maple
 Woodgrain finish: 05-Cherry 07-Walnut 08-Medium Oak

Register Stand Options (All styles unless specified):

Item#	Description
CRSFL	Light for combo register stand only
CRSRL	Ratchet lock for combo register stand only
RSPL	Plunger lock
RSRSD	1/4" white wood sliding rear doors (set)
RSHPL	Additional charge for exterior HPL finish
RSD	Drawer- 6" High Front

LPL white interior standard. Exterior custom HPL finishes are available from Formica, Wilsonart, and Nevamar. Allow a 3-4 week lead time. Solid colors or woodgrains in matte finish only. All other brands and finishes priced upon request. Additional crating charge of \$20.00 per unit.

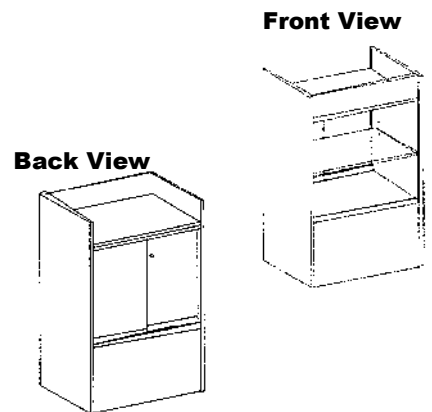
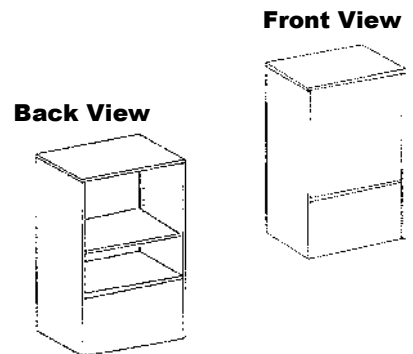
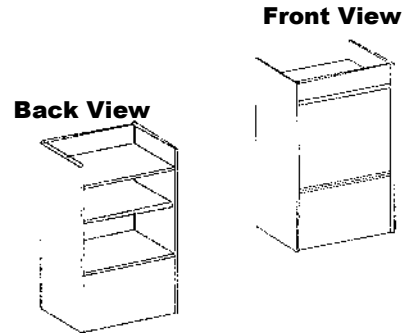



Corner Fillers

The modular design of these corner fillers give you the freedom to design your own unique layout. They are available in three styles for flexibility of design. Units are 38" high.

Closed Corner Filler

Item#	Width	Depth	Weight
CLCF1818##	18"	18"	90
CLCF2424##	24"	24"	105

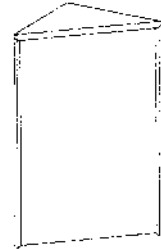

Open Corner Filler

Features:

- Two adjustable glass shelves

Item#	Width	Depth	Weight
OCF1818##	18"	18"	90
OCF2424##	24"	24"	105

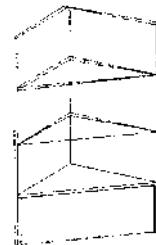

Combo Corner Filler

Features:

- Durable 3/4" laminate construction
- Low pressure laminate exterior and interior finish for durability
- Solid top and one adjustable glass shelf

Item#	Width	Depth	Weight
COF1818##	18"	18"	90
COF2424##	24"	24"	105

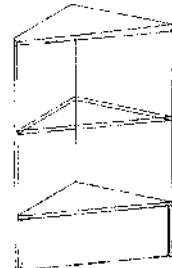

##-Specify finish (low pressure laminate matte finish)

Standard finish: 01-Almond 02-Black 03-Gray 04-White 06-Maple

Woodgrain finish: 05-Cherry 07-Walnut 08-Medium Oak

Corner Filler Options:

Item#	Description
CFHPL	Additional charge for exterior HPL finish (all styles)
CFGS	Additional glass shelf

LPL white interior standard. Exterior custom HPL finishes are available from Formica, Wilsonart, and Nevamar. Allow a 3-4 week lead time. Solid colors or woodgrains in matte finish only. All other brands and finishes priced upon request.

Additional crating charge \$20.00 per unit. Shipping weights are approximate per crate.

Phone 877-785-6642

Fax 262-878-5030

Email: Sales@Retailonics.com



Wall Units

The 57" high viewing area and adjustable shelves provide a versatile space from the retail industry to the small collector. Wall units are 78", 18" deep and come in 36" and 48" widths.

Features:

- 3/16" tempered glass sliding doors
- Four adjustable tempered glass shelves 15" deep
- Steel standards and brackets (48" unit only)
- 57" high front viewing area
- White interior deck and 1/4" solid wood back (48" unit has 3/4" back)
- Factory installed light fixture
- Quality showcase lock

Item#	Width	Depth	Weight
WU3618##	36"	18"	330
WU4818##	48"	18"	420

##-Specify finish (low pressure laminate matte finish)

Standard finish: 01-Almond 02-Black 03-Gray 04-White 06-Maple

Woodgrain finish: 05-Cherry 07-Walnut 08-Medium Oak

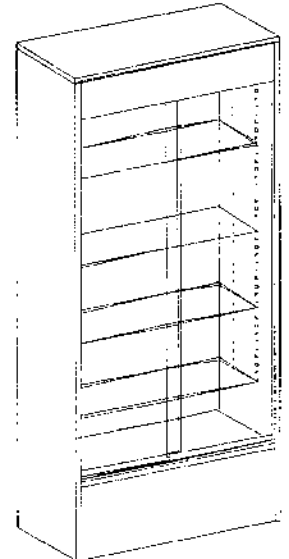

Wall Unit Options:

Item#	Description
WU36HPL	Additional charge for exterior HPL finish- 36" unit
WU48HPL	Additional charge for exterior HPL finish- 48" unit
WUGS36	Additional glass shelf - 36" unit
WUGS48	Additional glass shelf - 48" unit
WUMB36	Mirrored back for 36" unit
WUMB48	Mirrored back for 48" unit

LPL white interior standard. Exterior custom HPL finishes are available from Formica, Wilsonart, and Nevamar. Allow a 3-4 week lead time. Solid colors or woodgrains in matte finish only. All other brands and finishes priced upon request. Additional crating charge of \$20.00 per unit.

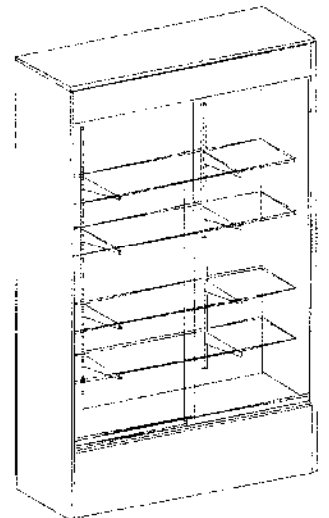

**1 Year Guarantee
on All Woodwork!**



Serving Stations

The space saving design and durable construction of these units makes them an excellent addition to any service environment. These units are 36" high.

Basic Serving Station

Features:

- Open storage area with 3/4" adjustable storage shelf
- Utensil drawer with six compartments
- Front 4" High recessed toe kick
- 4" High back splash

Item#	Width	Depth	Weight
BS3618##	36"	18"	195
BS4824##	48"	24"	210
BSD##	Doors for 36" unit		30
BSUS##	Upper shelf for 36" unit		45

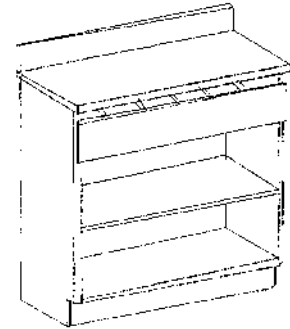

##-Specify finish (low pressure laminate matte finish)
 Standard finish: 01-Almond 02-Black 03-Gray 04-White 06-Maple
 Woodgrain finish: 05-Cherry 07-Walnut 08-Medium Oak

Deluxe Serving Station

Features:

- Open storage area with center divider, two adjustable storage shelves
- Two utensil drawers include four compartments per drawer
- Front 4" High recessed toe kick
- 4" High back splash

Item#	Width	Depth	Weight
DS4818##	48"	18"	200
DS4824##	48"	24"	215
DSD##	Doors for 48" unit		35
DSUS##	Upper shelf for 48" unit		55

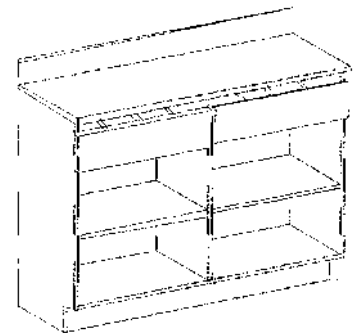

##-Specify finish (low pressure laminate matte finish)
 Standard finish: 01-Almond 02-Black 03-Gray 04-White 06-Maple
 Woodgrain finish: 05-Cherry 07-Walnut 08-Medium Oak

Serving Station Options:

Item#	Description
SS36HPL	Additional charge for exterior HPL finish - 36"
SS48HPL	Additional charge for exterior HPL finish - 48"
SSDHPL	HPL finish - doors - all sizes
SSUSHPL	HPL finish - upper shelf - all sizes

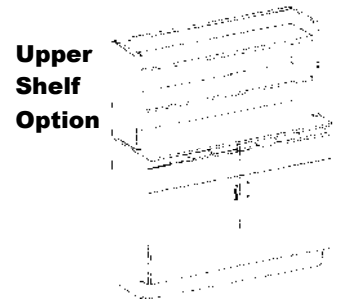

LPL white interior standard. Exterior custom HPL finishes are available from Formica, Wilsonart, and Nevamar. Allow a 3-4 week lead time. Solid colors or woodgrains in matte finish only. All other brands and finishes priced upon request. Additional crating charge of \$20.00 per unit. Shipping weights are approximate per crate.



Reservation Stand

This mobile stand features a contemporary design and looks great in any surrounding. It includes an angled top with pencil rest. This unit is 45 1/2' high x 16" deep x 23" wide.

Features:

- Durable 3/4" laminate construction
- Open rear storage area with 3/4" adjustable storage shelf
- Four 2" durable casters for easy mobility (two locking)
- 3/4" slanted top surface with pencil rest

Item#	Width	Depth	Weight
RS2316##	23"	16"	180
RSBL	Antique brass light fixture (optional)		
RSHPL	Additional charge for HPL finish		

##-Specify finish (low pressure laminate matte finish)
 Standard finish: 01-Almond 02-Black 03-Gray 04-White 06-Maple
 Woodgrain finish: 05-Cherry 07-Walnut 08-Medium Oak

LPL white interior standard. Exterior custom HPL finishes are available from Formica, Wilsonart, and Nevamar. Allow a 3-4 week lead time. Solid colors or woodgrains in matte finish only. All other brands and finishes priced upon request.

Front View

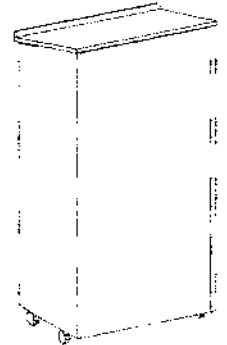

Back View

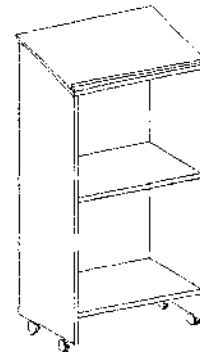

Display Risers

Display risers are an economical solution for all your merchandising needs. These units can be combined to create various configurations for your own unique style. Risers are 4" deep and are available in 4" and 8" heights.

Features:

- Durable 3/4" laminate construction
- Available in black finish only

Item#	Width	Depth	Height	Weight
DR2444	24"	4"	4"	7
DR2448	24"	4"	8"	9
DR3644	36"	4"	4"	11
DR3648	36"	4"	8"	13
DR4844	48"	4"	4"	13
DR4848	48"	4"	8"	15

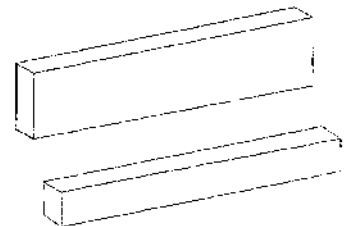

Additional crating charge of \$20.00 per unit.

Custom sizes and finishes are available. Please contact you sales associate for more information.



Convenience Counters

Designed to meet the needs of the growing convenience market, these counters offer versatility, function and value. The durable laminate construction requires minimal maintenance and is designed to withstand high traffic areas. These units give you the look of high end custom units at an affordable price.

Storage Counter

Features:

- 26" deep x 40" high counter height
- Durable 1 1/8" thick top
- Front 4" high recessed toe kick
- 3/4" hinged doors with interior adjustable shelf
- 4" high rear backsplash
- LPL white interior and exterior back

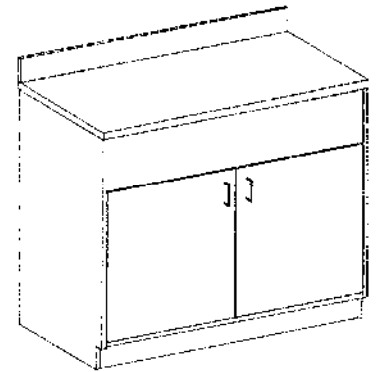

Item#	Width	Depth	Weight
SC3626##	36"	26"	240
SC4826##	48"	26"	275
SC6026##	60"	26"	325

##-Specify finish (low pressure laminate matte finish)
 Standard finish: 01-Almond 02-Black 03-Gray 04-White 06-Maple
 Woodgrain finish: 05-Cherry 07-Walnut 08-Medium Oak

Storage Counter Options:

Item#	Description
SC36HPL	Additional charge for exterior HPL finish- 36" unit
SC48HPL	Additional charge for exterior HPL finish- 48" unit
SC60HPL	Additional charge for exterior HPL finish- 60" unit
SCSSL	4" stainless steel legs
SCHDC	2 1/2" heavy duty casters

LPL white interior standard. Exterior custom HPL finishes are available from Formica, Wilsonart, and Nevamar. Allow a 3-4 week lead time. Solid colors or woodgrains in matte finish only. All other brands and finishes priced upon request. Additional crating charge of \$20.00 per unit.

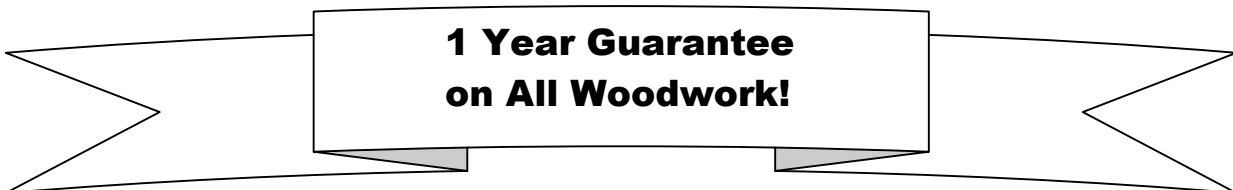



Fountain Unit

Features:

- 26" deep x 40" high counter height
- Durable 1 1/8" thick top
- Front 4" high recessed toe kick
- Three cup holder cutouts (cup holders not included) 5 3/8" diam.
- 3/4" hinged doors with interior adjustable shelf
- 4" high rear backsplash
- LPL white interior and exterior back

Item#	Width	Depth	Weight
FTU3626##	36"	26"	240
FTU4826##	48"	26"	275
FTU6026##	60"	26"	325

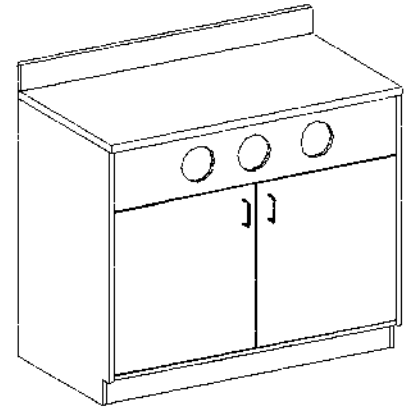

##-Specify finish (low pressure laminate matte finish)

Standard finish: 01-Almond 02-Black 03-Gray 04-White 06-Maple

Woodgrain finish: 05-Cherry 07-Walnut 08-Medium Oak

Fountain Unit Options:

Item#	Description
FTU36HPL	Additional charge for exterior HPL finish- 36" unit
FTU48HPL	Additional charge for exterior HPL finish- 48" unit
FTU60HPL	Additional charge for exterior HPL finish- 60" unit
FTUSSL	4" stainless steel legs
FTUHDC	2 1/2" heavy duty casters

LPL white interior standard. Exterior custom HPL finishes are available from Formica, Wilsonart, and Nevamar. Allow a 3-4 week lead time. Solid colors or woodgrains in matte finish only. All other brands and finishes priced upon request. Additional crating charge of \$20.00 per unit.

Not finding what you are looking for?

At Retailonics, we have the ability to customize any fixture to meet the needs of your next project. We are experienced in a wide variety of materials including veneer, laminate, solid wood and glass.

Let our skilled craftsmen bring your project to life. Contact your sales representative for more information.



Condiment Unit

Features:

- 26" deep x 40" high counter height
- Durable 1 1/8" thick top
- Front 4" high recessed toe kick
- Built in fixed front compartments.
- 3/4" hinged doors with interior adjustable shelf
- 4" high rear backsplash
- LPL white interior and exterior back

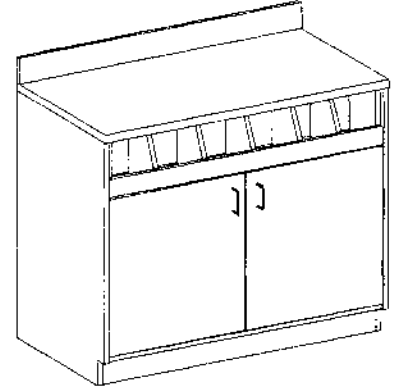

Item#	Width	Depth	Weight
CU3626##	36"	26"	260
CU4826##	48"	26"	310

##-Specify finish (low pressure laminate matte finish)
 Standard finish: 01-Almond 02-Black 03-Gray 04-White 06-Maple
 Woodgrain finish: 05-Cherry 07-Walnut 08-Medium Oak

Condiment Unit Options:

Item#	Description
CU36HPL	Additional charge for exterior HPL finish- 36" unit
CU48HPL	Additional charge for exterior HPL finish- 48" unit
CUSSL	4" stainless steel legs
CUHDC	2 1/2" heavy duty casters

LPL white interior standard. Exterior custom HPL finishes are available from Formica, Wilsonart, and Nevamar. Allow a 3-4 week lead time. Solid colors or woodgrains in matte finish only. All other brands and finishes priced upon request. Additional crating charge of \$20.00 per unit.

Determining the most effective layout of your foodservice fixtures is essential to the success of your business. The modular design of our convenience counters offers unlimited options to streamline your space.

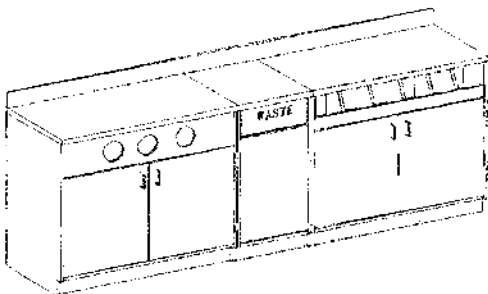

In addition to Retailonics stock items, we also offer design-build services with the fabrication of custom fixtures to solve even the most unique challenges.

Contact our sales team for more information.



Coffee Bar

Features:

- 48" wide x 20" deep x 38" high
- Durable 3/4" thick HPL top
- Heavy duty casters, 2 locking
- Accessible from both sides.
- Hinged doors with interior adjustable shelf
- 7 1/2" high swinging waste receptacle doors

Item#	Width	Depth	Weight
CB4820##	48"	20"	280

##-Specify finish (low pressure laminate matte finish)
 Standard finish: 01-Almond 02-Black 03-Gray 04-White 06-Maple
 Woodgrain finish: 05-Cherry 07-Walnut 08-Medium Oak

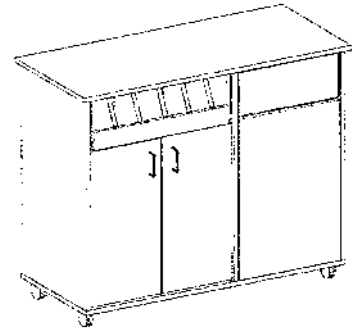

Coffee Bar Options:

Item#	Description
BHPL	Additional charge for HPL Base

LPL white interior standard. Exterior custom HPL finishes are available from Formica, Wilsonart, and Nevamar. Allow a 3-4 week lead time. Solid colors or woodgrains in matte finish only. All other brands and finishes priced upon request. Additional crating charge of \$20.00 per unit.

Waste Unit

Features:

- 20" wide x 26" deep x 40" high
- Durable 1 1/8" thick top
- Front 4" high recessed toe kick
- 6 3/4" high flip door, 25 gallon waste container included
- Easy to read "WASTE" in black or white lettering
- Single hinged door
- 4" high rear backsplash
- LPL white interior and exterior back

Item#	Width	Depth	Weight
WU2026##	20"	26"	175

##-Specify finish (low pressure laminate matte finish)
 Standard finish: 01-Almond 02-Black 03-Gray 04-White 06-Maple
 Woodgrain finish: 05-Cherry 07-Walnut 08-Medium Oak

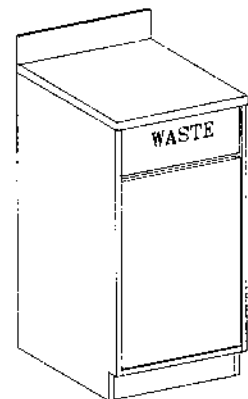

Waste Unit Options:

Item#	Description
WUHPL	Additional charge for HPL finish
WUSSL	4" stainless steel legs
WUHDC	2 1/2" heavy duty casters

LPL white interior standard. Exterior custom HPL finishes are available from Formica, Wilsonart, and Nevamar. Allow a 3-4 week lead time. Solid colors or woodgrains in matte finish only. All other brands and finishes priced upon request. Additional crating charge of \$20.00 per unit.

Phone 877-785-6642 Fax 262-878-5030 Email: Sales@Retailonics.com



Three Tier Merchandising Table

The functional design and durable construction of the three tier merchandising table allows you to optimize your display space and makes it an excellent addition for any service environment.

Features:

- Overall height 42"
- Bottom shelf: 60" x 42"
- Middle shelf: 60" x 30"
- Top shelf: 48" x 18"
- Available with square or rounded corners
- Ships KD – assembles quickly and easily
- 6" high recessed toe base
- Standard colors and Maple have T-nosing to match, all other woodgrains have black t-nosing

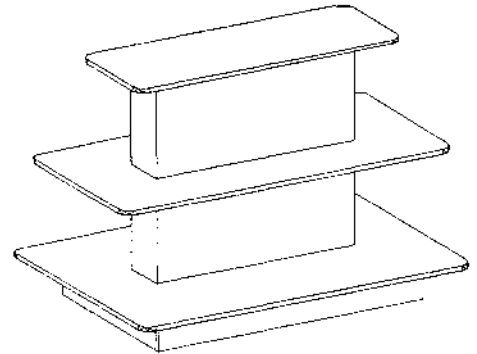

Item#	Style	Weight
TTMTR##	Rounded corners	275
TTMTS##	Square corners	275

##-Specify finish (low pressure laminate matte finish)
 Standard finish: 01-Almond 02-Black 03-Gray 04-White 06-Maple
 Woodgrain finish: 05-Cherry 07-Walnut 08-Medium Oak

Four Tier Merchandising Table

Similar in styling to the three tier table, this unit allows you to maximize your merchandising space.

Features:

- Overall height 52"
- Bottom shelf: 48" x 42"
- Second shelf: 48" x 36"
- Third shelf: 36" x 30"
- Top shelf: 24" x 18"
- Available with square or rounded corners
- Ships KD – assembles quickly and easily
- 6" high recessed toe base
- Standard colors and Maple have T-nosing to match, all other woodgrains have black t-nosing

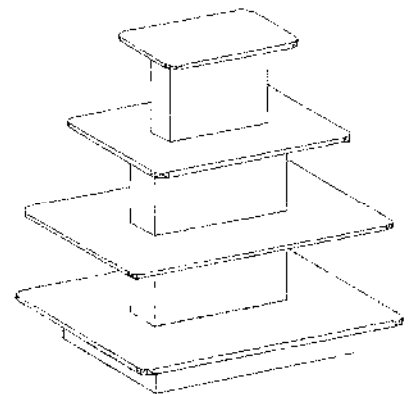

Item#	Style	Weight
FTMTR##	Rounded corners	300
FTMTS##	Square corners	300

##-Specify finish (low pressure laminate matte finish)
 Standard finish: 01-Almond 02-Black 03-Gray 04-White 06-Maple
 Woodgrain finish: 05-Cherry 07-Walnut 08-Medium Oak

Additional crating charge of \$20.00 per unit.

Phone 877-785-6642 Fax 262-878-5030 Email: Sales@Retailonics.com



Round Display Table

This innovative table ships KD to save you money yet its contemporary design allows you to maximize your merchandising space.

Features:

- Durable 3/4" laminate construction
- Circular surface: 30" diameter
- Overall height: 30"
- Ships KD – assembles quickly and easily

Item#	Diameter	Weight
RT30##	30"	42
RT30UF	30"	42

##-Specify finish (low pressure laminate matte finish)
 Standard finish: 01-Almond 02-Black 03-Gray 04-White 06-Maple
 Woodgrain finish: 05-Cherry 07-Walnut 08-Medium Oak

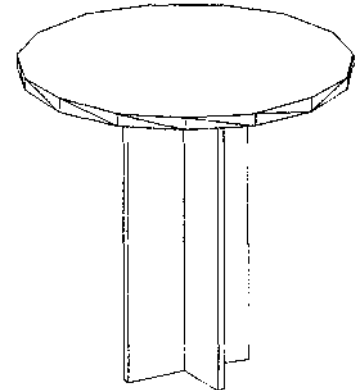

Folding Dump Table

Features:

- Durable 3/4" laminate construction
- 4" recessed well
- Black heavy duty steel legs
- Available in 48" and 60" lengths
- Overall height: 31"

Item#	Width	Depth	Weight
FDT48##	48"	24"	47
FDT60##	60"	24"	65

##-Specify finish (low pressure laminate matte finish)
 Standard finish: 01-Almond 02-Black 03-Gray 04-White 06-Maple
 Woodgrain finish: 05-Cherry 07-Walnut 08-Medium Oak

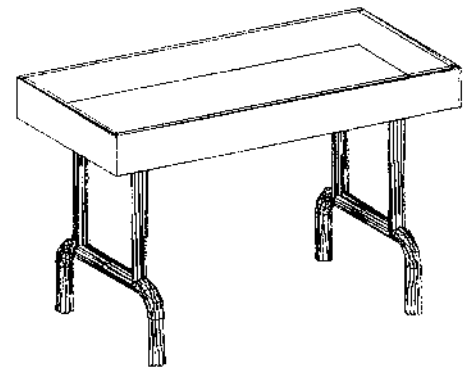

Wood Shelves

Features:

- 3/4" thick melamine construction
- Available in solid or woodgrain finishes
- Finished on 1 long edge and 2 short edges
- Packed two per carton (prices shown are per carton)

Item#	Width	Length	Weight
WS1224##	12"	24"	12
WS1248##	12"	48"	24
WS1424##	14"	24"	16
WS1448##	14"	48"	26
WSBS	1.5"	7"	1
WSBG	1.5"	7"	1

##-Specify finish (low pressure laminate matte finish)
 Standard finish: 01-Almond 02-Black 03-Gray 04-White 06-Maple
 Woodgrain finish: 05-Cherry 07-Walnut 08-Medium Oak

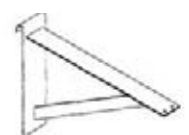
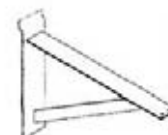
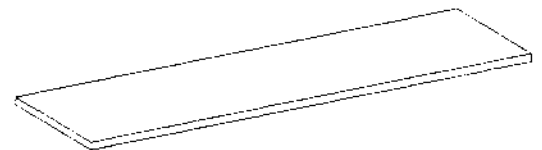

WSBS (Slatwall)

WSBG (Gridwall)



Slatwall Counter

This innovative design saves you valuable floor space. This unit offers you dual function – a service counter and a slatwall merchandiser combined into one.

Features:

- Durable ¾" construction, 38" high
- Available in 48", 60" and 70" lengths
- Open rear storage with ¾" adjustable storage shelf
- Center divider panel for added support (60" and 70" widths only)
- 24" deep top, 18" deep base unit, 3" on center slatwall front

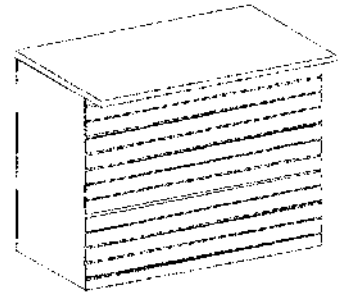

Item#	Width	Depth	Weight
SC4824##	48"	24"	240
SC6024##	60"	24"	275
SC7024##	70"	24"	325

##-Specify finish (low pressure laminate matte finish)
 Standard finish: 02-Black or 03-Gray only

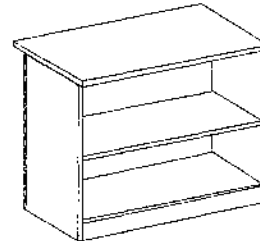

Island Display

The Island Display provides versatile merchandising capabilities by allowing access from every angle.

Features:

- Solid low pressure base: 13 ½" high x 30" deep
- Heavy duty steel standards and brackets
- Three rows of adjustable tiered glass shelves: 8" deep, 10" deep & 12" deep
- Available in 48" and 60" lengths

Item#	Width	Length	Weight
ID3048##	30"	48"	195
ID3060##	30"	60"	220

##-Specify finish (low pressure laminate matte finish)
 Standard finish: 01-Almond 02-Black 03-Gray 04-White 06-Maple
 Woodgrain finish: 05-Cherry 07-Walnut 08-Medium Oak

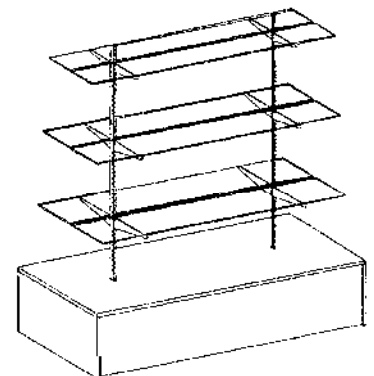

Island Display Options:

Item#	Description
IDLSD	Lower storage with 1/4" sliding doors
IDHPL	Additional charge for HPL finish

LPL white interior standard. Exterior custom HPL finishes are available from Formica, Wilsonart, and Nevamar. Allow a 3-4 week lead time. Solid colors or woodgrains in matte finish only. All other brands and finishes priced upon request
 Additional crating charge \$20.00 per unit. Shipping weights are approximate per crate.



RETAILONICS

Slatwall Merchandiser Systems

These units offer you the versatility of different shelf styles with the rich beauty of wood.

Features:

- Durable construction
- All units are 54" high
- 3" on center slatwall
- All units assemble easily

Item#	Width	Panel Width
SWF2448##	36" Sqr.	24" x 48"
SWT2448##	24" x 25.5"	24" x 48"
SWC2448##	24" x 25.5"	24" x 48"
SWI4848##	49.5" x 24"	48" x 48"

##-Specify finish (low pressure laminate matte finish)

Standard finish: 03-Gray 04-White 06-Maple



SWF244806



SWT244806



SWC244806



SWI484804

Please see page 23 for compatible wood shelves
or page 33 for specialty wire shelves



Storage Cabinets

These all steel lockable storage cabinets provide a host of options to keep your items secure and organized.

Features:

- All embossed steel construction
- Full suspension roll-out drawers
- No assembly required- ready to use immediately
- Stackable
- Adjustable levelers
- Units can be bolted together for security
- Includes lock and keys

Item#	Length	Height	Deep
STC2D##	37.5"	14.5"	20"
STC3D##	37.5"	20.5"	20"

##-Specify finish

Standard finish: 02-Black 03-Gray 04-White 09-Beige

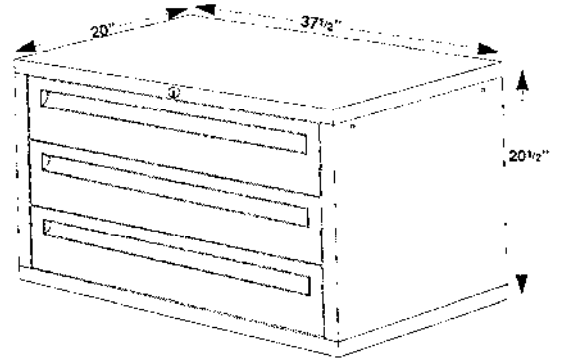
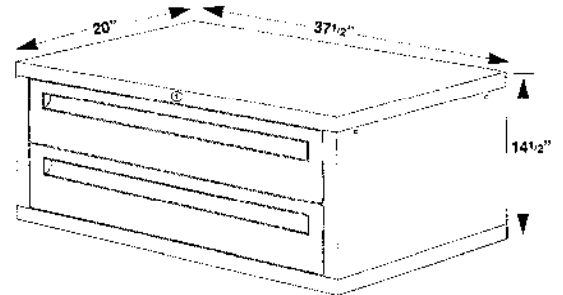

Storage Cabinet Options:

Item#	Description
STCOD	Adjustable eggcrate divider kit (1 needed per drawer)
STBASE	Black metal caddy



The steel adjustable eggcrate divider allows for 3 different compartment configurations:

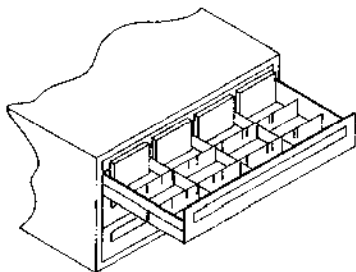

Twelve 8 1/8" long x 5" deep compartments

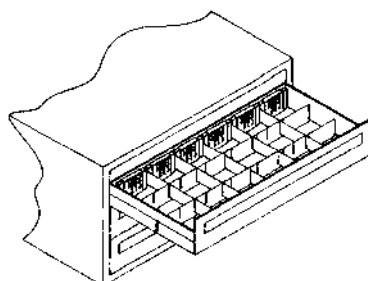

Eighteen 5 1/2" long x 5" deep compartments

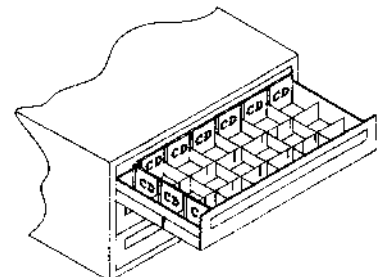

Eighteen 5" long x 5" deep compartments plus three 3" long x 5" deep compartments



Dump Bins

These large capacity wire dump bins knock down for easy storage.

Features:

- Removable locking casters included
- Adjustable bottom

Item#	Width	Depth	Height
MB1830##	18"	18"	30"
MB2630##	26"	26"	30"

##-Specify finish

Standard finish: 02-Black or 04-White Only



Multipurpose Peg Spinner

This economical peg spinner shows off your merchandise from all angles to promote impulse sales.

Features:

- Four tiers
- 6" long hooks
- Chrome plated for durability

Item#	Width	Depth	Height
MPS63	18"	15"	63"



Three Basket Spinner

This heavy duty dump bin spinner allows you to merchandise large bulk items with ease.

Features:

- 6" deep baskets
- Top basket: 18" diameter
- Middle basket: 21" diameter
- Bottom basket: 24" diameter
- 76" height for maximum visibility
- Chrome plated for durability

Item#	Description	Height
TBS76	3 Tier basket spinner	76"

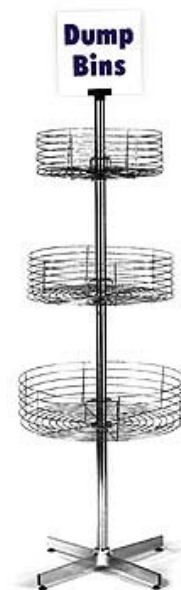



Adjustable Wire Shelving Racks

These wire racks offer you the flexibility of extra storage and merchandising capabilities that look good in the front of your operation or the back.

Features:

- **Heavy duty construction**
- **Adjustable shelves**
- **Installs in minutes with no tools**

63" High Sets (includes 4 Shelves)				
Item#	Height	Depth	Width	
WS631836##	63"	18"	36"	
WS631848##	63"	18"	48"	
WS632436##	63"	24"	36"	
WS632448##	63"	24"	48"	

##-Specify finish

Standard finish: 02-Black Powder Coat or 11-Chrome only

74" High Sets (includes 4 Shelves)				
Item#	Height	Depth	Width	
WS741848##	74"	18"	48"	
WS742448##	74"	24"	48"	

##-Specify finish

Standard finish: 02-Black Powder Coat or 11-Chrome only

Individual Shelves (4 per box)			
Item#	Depth	Width	
IS1836##	18"	36"	
IS1848##	18"	48"	
IS2436##	24"	36"	
IS2448##	24"	48"	

##-Specify finish

Standard finish: 02-Black Powder Coat or 11-Chrome only



Don't see what you are looking for?

We have many trusted suppliers both domestic and overseas available to us. Please contact our sales department and let us be your one-stop source.



RETAILONICS

Adjustable Display Racks

These racks offer you the ease of adjustability while still giving your products eye-appeal. Just roll them out to increase sales.

Features:

- **Portable** – Castors included
- **Adjustable** – Mounting holes are 1" apart
- **Ease** – Assembles in minutes
- **Versatility** – 4 styles to choose from
- **Available in white only**

Item#	Height	Number of Shelves	Width
ADR6S57	65"	6	24"
ADR5B412	65"	5	24"
ADR6H58	65"	6	24"
ADR7DVD	65"	7	24"

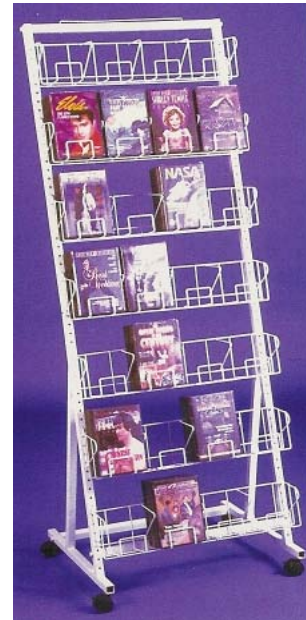

ADR7DVD



ADR5B412
Great for small
impulse items



ADR6H58
8" Long hooks



ADR6SH7

Phone 877-785-6642

Fax 262-878-5030

Email: Sales@Retailonics.com



Wire Display Rack

This fold-open shelf floor display is great for close-outs and seasonal displays while being sturdy enough for permanent use.

Features:

- No tools need – assembles in minutes
- Available in black only

Item#	Height	Depth	Width
WDR5522	55"	13"	22"
WDRSHELF	Additional shelf		

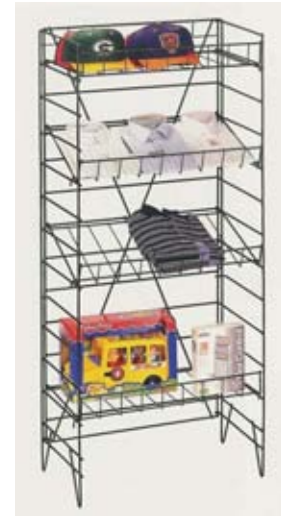

Fold Open Literature Rack

This literature rack is great for magazine or trade show use. 10 open shelves allow you to display books, magazines, product literature, software or other small items.

Features:

- No tools need – assembles in minutes
- Available in black only

Item#	Height	Depth	Width
FOLR4628	46"	21 1/2"	28 1/2"



Newspaper Rack

Features:

- No tools need – assembles in minutes
- Available in black only

Item#	Height	Depth	Width
NEWS3715	37"	15"	16"





RETAILONICS

Write-On & Wash-Off A-Frame

Used indoor or out this handy message board will get your point across. The special rain resistant fluorescent paint markers erase with window cleaner.

Features:

- 39 1/2" High x 24" Wide x 28" Deep
- Black board/ black frame or white board/ black frame
- Markers sold separately – see below

Item#	Description
AFBLKB	Black Marker Board A-Frame
AFBLMKR	Marker set - for AFBLKB
AFWHB	White Marker Board A-Frame
AFWHMKR	Marker set - for AFWHB

AFBLMKR Set - 1 each of White, Violet, Yellow, Blue & Pink markers

AFWHMKR Set - 1 each of Blue, Red, Pink, Black & Green markers



Wire Countertop Display Racks

These racks put your merchandise in front of your customers to promote impulse sales.

Item#	Description	Height	Width	Depth
WCR3S2412	3-adjustable shelf rack	24"	24"	12"
WCRL2218	6-step literature rack	22"	29 1/2"	18"
WCRSTEP	3-Step shelf rack	12 3/4"	23 1/2"	14"



WCRSTEP



WCRL2218



WCR3S2412

Phone 877-785-6642

Fax 262-878-5030

Email: Sales@Retailonics.com



Slatgrid And Standard Grid Panels

These panels allow you a variety of options to display your merchandise.

Slatgrid - These panels accommodate grid or slatwall accessories.			
Item#	Width	Length	
SLAT24#	2'	4'	
SLAT25#	2'	5'	
SLAT26#	2'	6'	
SLAT28#	2'	8'	

##-Specify finish

Standard finish: 02-Black 04-White

3" Standard grid panels			
Item#	Width	Length	
GRID24#	2'	4'	
GRID25#	2'	5'	
GRID26#	2'	6'	
GRID28#	2'	8'	

##-Specify finish

Standard finish: 02-Black 04-White 11-Chrome

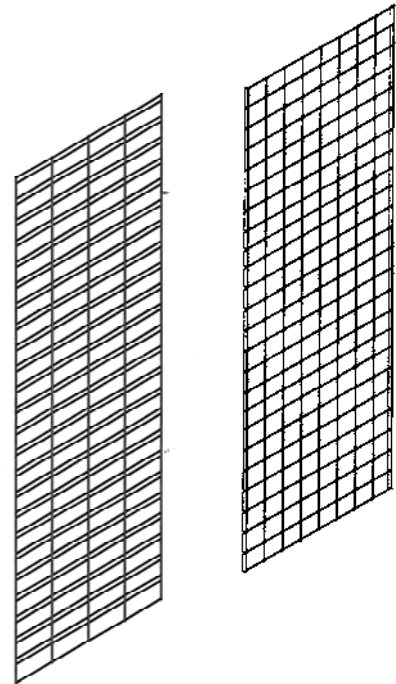

We also have a variety of Slatgrid and Grid accessories – please contact us for more details

Grid Panel Merchandisers

These portable displays allow you to easily put your merchandise in front of your customers.

Features:

- Assembles in minutes
- Includes heavy duty casters
- Three & Four Way Displayers have 1" heavy duty metal frames for strength.

Item#	Width	Height	
MS26#	2'	6'	
FWD25#	Four 2' x 5' connected panels		
TWD26#	2'	5'	

##-Specify finish

Standard finish: 02-Black 04-White

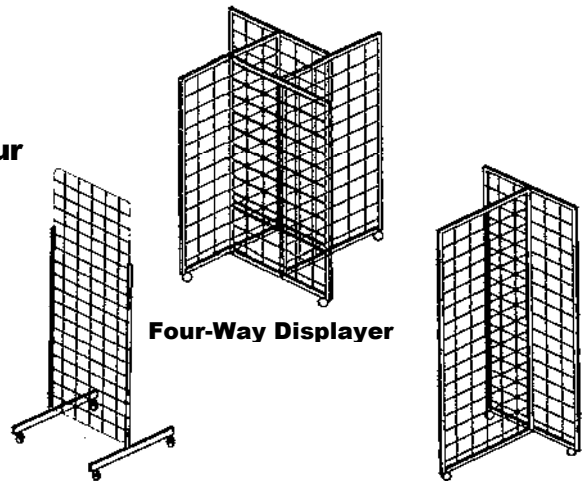

Mobile Shopper

Four-Way Displayer

Three-Way Displayer

See pages 23 for compatible wood shelves or page 33 for specialty wire shelves

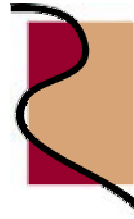

Shelves

Put your merchandise in front of your customers using a variety of shelving options.



UM2463



UM24610



UMB2436

Universal Mount- These shelves work on grid, pegboard or slatwall.				
Item#	Depth	Height	Length	
UM2463	3.5"	6.5"	24"	
UM24610	10"	6.5"	24"	
UMB2436	3.5" front lip	6.5"	24"	



SM2466



SMPD135

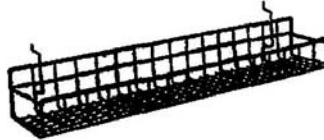

SMPD2333



SMSS24612

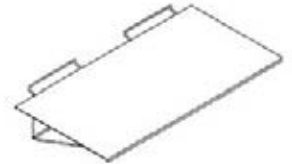

SMFSS2312

Slatwall Mount- These shelves work on slatwall & pegboard only.				
Item#	Depth	Height	Length	
SM2466	6"	6"	24"	
SMPD135	4.5"	5.5"	13.5"	
SMPD2333	3"	6.5"	23"	
SMSS24612	12"	6"	24"	
SMFSS2312	12"	Flat-Solid	23"	



GD2466



GDPD135



GDPD2333

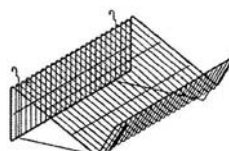

GDSS24612



GDFSW2315



GDFSS2312

Grid Mount- These shelves work on grid only.				
Item#	Depth	Height	Length	
GD2466	6"	6.5"	24"	
GDPD135	4.5"	5.5"	13.5"	
GDPD2333	3"	6.5"	23"	
GDSS24612	12"	6"	24"	
GDFSW2315	15"	Flat- Wire	23.5"	
GDFSS2312	12"	Flat-Solid	23"	

See page 23 for wood shelves and brackets



Merchandising Impulse Table

Features:

- Easy to assemble
- Portable – roll out for overstock or seasonal items
- Versatile – Use as a table or dump bin

Item#	Height	Width	Length	List
IT3324	33"	24"	42"	\$155.00

Specify Color : **BLK-Black** **WH-White**



Remove top and use as a dump bin



Swinging door for storage

Sure 'N Fast Counterfeit Detector

Sure 'N Fast Counterfeit Detector is a new and innovative way to detect the new style counterfeit currency.

Features:

- Detects counterfeit inks on washed or bleached paper bills
- More effective than the detector pens that work off of PH
- Economical - Each bottle tests over 1,000 bills
- 99% success rate on counterfeit bills
- Applicator will not dry out even if you lose the cover

Item#	Description	List
SNFCD	Sure 'N Fast	\$11.95

Full carton discounts available.





RETAILONICS

Custom Neon & LED Signs

We offer complete customization of Neon & LED signs. Please contact us for more information.



Phone 877-785-6642

Fax 262-878-5030

Email: Sales@Retailonics.com



RETAILONICS

6804 Green Bay Road
Suite 114 Unit 116
Kenosha, WI 53142

Phone 262-878-5046
Fax: 262-878-5030

Credit Application

Company Information:

Company Name: _____

Date: _____

Address: _____

Phone: _____

City: _____ State: _____ Zip Code: _____

Fax: _____

Type of Ownership: Proprietorship Partnership Corporation

Email: _____

Years in Business: _____ Annual Net: _____

Fed Tax ID: _____

Resale Tax ID # _____

Owners, Partners, Officers (Name and Title):

Bank Information:

Bank Name: _____ Address: _____ Account#: _____

Contact Name: _____ Fax: _____

Trade References:

Company Name: _____ Address: _____

Contact Name: _____ Fax: _____ Phone: _____

Company Name: _____ Address: _____

Contact Name: _____ Fax: _____ Phone: _____

Company Name: _____ Address: _____

Contact Name: _____ Fax: _____ Phone: _____

I authorize the following companies to release credit information to Retailonics Inc Kenosha,WI

Agreement:

It is understood that Retailonics Inc. may impose a penalty of late payment of one and a half (1.5) percent per month, on any past due balances and that the undersigned will pay costs of collection, including a reasonable attorney's fee. The undersigned agree that if the credit is granted by Retailonics Inc, the undersigned will be responsible for all invoices as presented. In consideration of granting of credit by Retailonics Inc. to the persons or companies to whom credit is pursuant to the above application, the undersigned, as an individual, not as an officer or corporation unconditional, jointly and severally guarantee(s) payment for all purchases made by said person or company. In addition, the undersigned guarantee(s) payment of any late fees and costs of collection, including a reasonable attorney's fee. The undersigned waive notice acceptance of this guarantee and notice of default and demand of every kind, nature and description and waive notice of the accrual of any obligation of liability of any such persons or companies or the undersigned. This shall be a continuing guarantee and shall not be affected by any extension of time, payment modifications or additions.

Signature/ Title: _____ Signature/ Title: _____



RETAILONICS

Terms and Conditions

Ordering

In a business that can be highly detailed in terms of product specifications, it is imperative that we receive a clearly specified, written order to avoid mistakes. All business related specifications to product, pricing, lead time, ship dates, invoice and debt etc., should be done via fax. Faxed orders are preferred to eliminate verbal mistakes. We strongly urge two-way communication via phone when questions and answers are vital. The actual commitment to the business transactions will only be communicated by fax.

Please be sure the following is on your order:

- Business name
- Contact person
- Phone & fax number (email address if available)
- Purchase order or your reference number

You will be faxed an Order Confirmation within 48 hours of receiving your purchase order. If you do not receive confirmation within that timeframe please call a customer representative at 877-785-6642.

Order confirmations are very important, please review them carefully for any errors. If you find an error on your order please contact customer service immediately. Your Silence is Your Order Approval.

To serve you better, we provide customer service Monday through Friday 8:00 am to 4:30 pm central standard time.

Change in Orders

Any change to an original purchase order is subject to Retailonics acceptance. We reserve the right to charge up to 15% of the original P.O., in addition to material and labor for all order changes.

Taxes

Wisconsin state sales tax will be applied when applicable.

Prices

Prices are reviewed periodically and subject to change without notice. Custom orders may require a 50% deposit before we will begin processing the paperwork. If a deposit is required it will be noted on your proposal.

Payment Terms

All orders will ship prepaid or C.O.D. unless credit has been established. Account balances over 30 days will be assessed a monthly finance charge of 1.5%. A \$25.00 service fee will be charged for any stop payments or NSF checks. Shipments may be held if a past due situation exists.

30-Day terms are available on acceptance of completed credit application. All open accounts are Net 30 days from date of the invoice unless stated otherwise.



RETAILONICS

Terms and Conditions

Shipments

All shipments are F.O.B. factory by common carrier best way. If special routing is required, please indicate when placing your order. Retailonics assumes no responsibility for damages or delays during shipment. In the unfortunate event that merchandise is damaged during shipment, please follow these guidelines to help resolve the situation in a timely manner:

- Count all packages upon receipt of your order.
- NEVER accept merchandise before thoroughly examining it.
- Save all original packaging materials.
- Do not sign for packages or bill of lading without notation of damage.
- Claims for damaged goods, concealed or otherwise should be filed directly with the carrier.
- Contact our customer service department immediately.

All merchandise has been packaged and inspected prior to shipping to insure you receive quality product. To minimize damage some items will require being crated or specially packaged, a crating charge will be applied per unit.

Returns / Cancellations

Orders to be returned or cancelled must have prior authorization from Retailonics. Returns and cancellations will be subject to a restocking fee of 25% and the customer will be responsible for return transportation. All returns or cancellation requests must be made in writing. Returns will be accepted within 30 days from date of receipt of shipment and must be received in original packaging. No unauthorized returns will be accepted. Customer assumes all charges incurred due to unauthorized return. Custom orders may not be returned.

Product Guarantee

Retailonics offers a limited warranty for one year from the date of the invoice on all wood products. We warrant that our products will be free of defects in material and workmanship. Retailonics cannot be held responsible or liable for product failure that occurs as a result of the product being subject to improper storage, application of product, or handling method. Retailonics makes no other claims or warranties whatsoever, whether expressed or implied, concerning its products.

